

Sailing Plus

MEGAYACHTS

SPM

FERETTI YACHTS NAVETTA 105



NAVETTA 31

Custom Line Yachts - 2007 / 2025 - 31.00M

ASKING PRICE: € 3,750,000

DESCRIPTION

M/Y HAG, the tri-deck Navetta 30 model, finished with a navy blue hull and white superstructure, is a timeless design by Zuccon International Project. Delivered by the Italian yard in 2007 she was refitted in 2023 and extensively refitted in 2025. Accommodation is for a party of 10 guests in four cabins and there are quarters for a crew of six. Her saloon, dining room and “massive” galley are all positioned on the main deck. The upper deck provides a TV lounge and ample seating and lying areas on deep sofas. On deck features include a sundeck Jacuzzi – next to a set of free weights! Al fresco dining is enjoyed on the aft deck, well protected under the substantial overhang.

The 189GT yacht’s top speed is 15 knots and cruising speed is 12 knots under twin 1,360hp MAN diesels. Range at 10 knots is 1,500 nautical miles.



KEY FEATURES

- **Impressive Volume**

Exceptional internal space, offering the feel of a much larger yacht. M/Y HAG is a pocket-sized mega yacht kept immaculately by her Owner.

- **Low Engine Hours**

Light private use and meticulous maintenance ensure the MAN main engines remain in excellent condition with low running hours.

- **Long Range**

Capable of long-range cruising, this yacht is ideal for extended voyages. At 10 knots, range is 1,500 nautical miles

- **Commercial Compliance**

RINA commercial classification ready, offering flexibility for private or charter use.

Length

31.00m/101'0ft

Gross Tonnage

185

Number of Guests

10

Beam

6.85 m

Year Built

2007/ 2025

Cabins

4

(1 x Master, 1 xVIP, 1x Twin,
1 x Double)

Draft

2.25 m

Main Engines

2x X MAN V12 (2 X 1360 HP)
3.150 hours

Hull

GRP

Type

Motor

Maximum Speed

15 Knots

Superstructure

GRP

Builder

Custom Line Yachts

Cruise Speed

12 Knots

CLASS

RINA

Hull/Superstructure: GRP / GRP

Deck material: Teak

External Designer: Zuccon International Project

Internal Designer: Paola Galeazzi, Zuccon International Project

Classification Society: RINA

MCA: No

Cruising Speed: 12.0 knots

Maximum Speed: 15.0 knots

PERFORMANCE

Range (nm): 1500nm @ 10kn

Generators: 2 x Kohler 33kW

Generator hours: 18000

PROPULSION & STEERING

Shaft lines

ZF transmission

Bow thruster

STABILISERS

Stabilisers at anchor: Yes

Stabilisers underway: Yes

Stabilisers details: Mitsubishi antirolling gyro and AB TRAC 250

MECHANICAL

Watermaker Idromar 2x180L

Air conditioning: CONDARIA CENTRAL CHILLER UNIT

Bow Thruster: TRAC, HYDRAULIC

Stabilizer: 3 x MITSUBISHI GYRO + TRAC 250 FIN

Boiler: ARISTON, 2 x 180 L

ELECTRICAL

Lumitec underwater lights

Generators: 2 x 33 kW KOHLER (7,300 hrs.)

Electrical voltage: 12V, 24V, 220V

Electrical WC system: JET VACUM SYSTEM

Black water system

Fresh water system

Grey water system

COMMUNICATION & NAVIGATION EQUIPMENT

Chart plotter: FURUNO

GPS: FURUNO

Radar: FURUNO (48 mile)

Automatic Identification System (AIS)

Depth Sounder: SIMRAD

Compass

Autopilot: SIMRAD

VHF Radio: SIMRAD

Speed Log: SIMRAD

PEPWAVE 4.5 G Communication system

















CUSTOM LINE



LINE

CUST











PROFILE

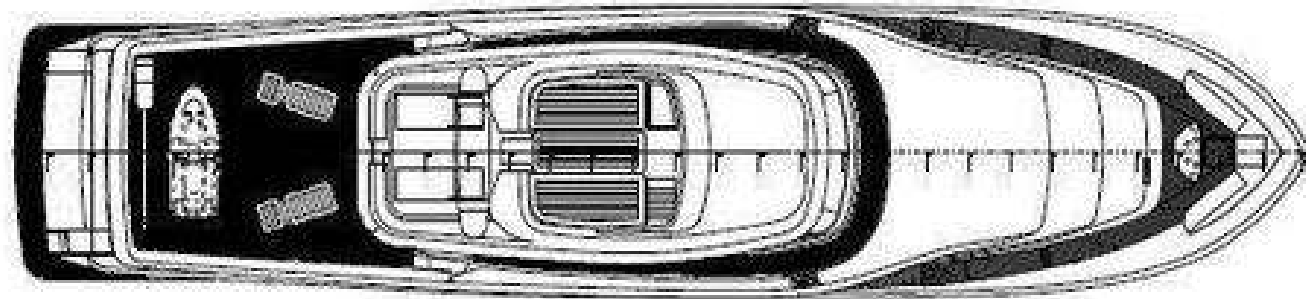

UPPER DECK

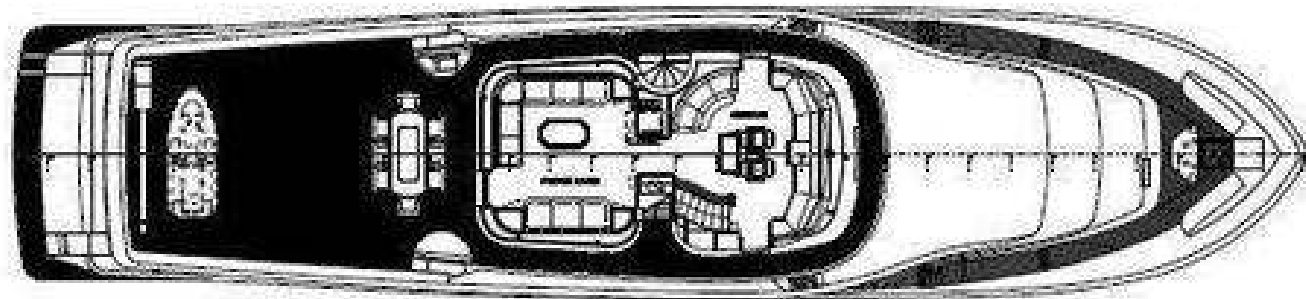

MIDDLE DECK

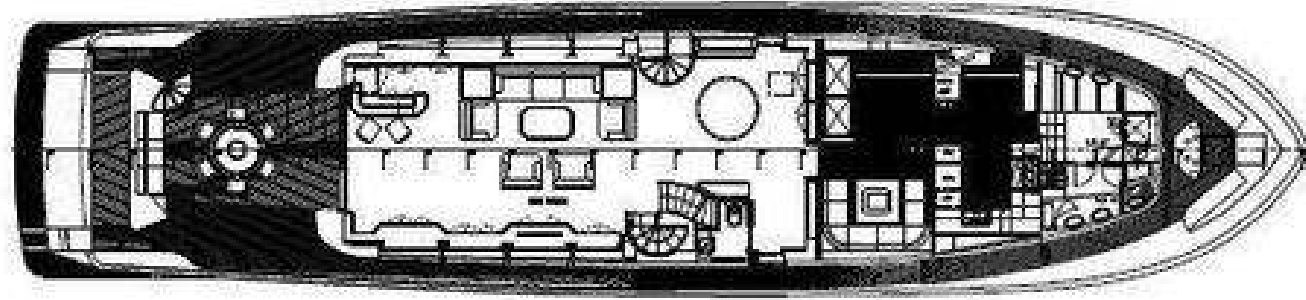

LOWER DECK

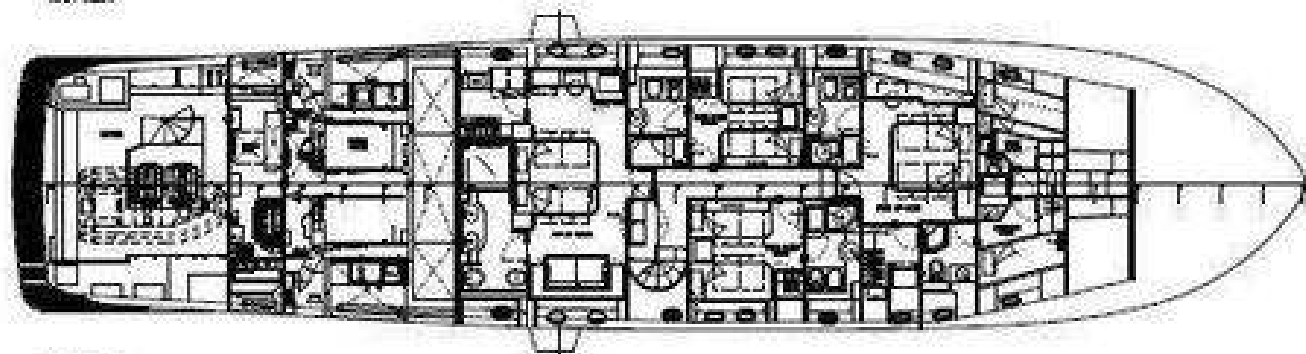

LOWEST DECK

<input checked="" type="checkbox"/> SUCCOR INTERNATIONAL PROJECT No. 1 21.00000000 - 000 000 000 - 000 000 000	
PROJECT NO. 1 PROJECT NAME PROJECT LOCATION	PROJECT NO. 1 PROJECT NAME PROJECT LOCATION
CUSTOM LINE ENGINEERING DEPT.	
GENERAL AGREEMENT CONTRACT NO.	DATE SCALE SHEET NO.

WWW.SAILINGPLUSMEGAYACHTS.COM
yachtsale@sailingplusmegayachts.com
+9613861361

The company is not liable for validity of the information provided by the yacht-owner (images, specification of the yacht, list of equipment installed, its operability, engine hours, legal aspects).

Actual engine hours are indicated at the moment of initial information placement and gets further periodically updated. Detailed information and characteristics will be provided on buyer's request and indicated in the contract.